Rascal Powerchair Model WeGo 250

Owners Manual & Service Record



WeGo 250

ELECTRIC MOBILITY EURO

Rascal

Electric Mobility Euro Limited, Canal Way, Ilminster, Somerset TA19 9DL
Telephone: 01460 258100 www.electricmobility.co.uk

CE

Issue 1: 11/09



WeGo 250

Electric Mobility Euro Ltd offers the Rascal WeGo 250 powerchair for convenient indoor and outdoor use. This manoeuvrable attendant operated powerchair provides a comfortable ride for people with disabilities who require to be driven by an attendant.

The WeGo 250 is designed for quick and easy stowing in a vehicle and reassembly at your destination.

Provided that this powerchair is maintained and operated in accordance with this manual it should last for many years.

Please read this manual thoroughly before using this powerchair. If you have any doubts about warnings or instructions, ask your dealer for an explanation. If at any time you feel you may not be able to control the vehicle safely, do not drive, but consult your dealer for a solution.

Notice

All Electric Mobility Wheelchairs are sold through authorised dealers. Make sure your dealer demonstrates all the features of the product prior to, or when, it is delivered.



Warning!

This manual contains important safety notices. Please take time to read and understand them. Ignoring them may endanger you or others.

Contents

Dealer information	4
Features and layout	4
Safety information	5
Intended use	5
Safety information	6
Driving	6
Component overview	8
Controls - Attendant controls	8
Controls - driving controls/accelerator	9
Freewheel device	10
Passenger Transfer Lock	10
Brakes	10
Armrest / width / angle adjustment	11
Swivel seat	11
Seat back folding	12
Footrest adjustment	12
Attendant tiller adjustment	12
Transferring in and out of the powerchair	12
Attendant operation	13
Driving your vehicle	14
Driving your vehicle - hazards	15
Transporting your powerchair	16
Assembling your powerchair	17
Battery charging	18
Charging your batteries	19
User maintenance	20
Servicing & maintenance	20
Engineer's checklist	21
Troubleshooting guide	22
Diagnostic table	22
Frequently asked questions	23
Additional safety information	23
Additional information	24
Technical specification	25
Guarantee & warranty	26
Technical information regarding EMI	26
Brochure request / Warranty card	27
Service log	29

Dealer Information

**This is your contact number
for service and support**

Dealer Stamp

Telephone:

Email:

Product Model Number

Serial Number

Date of Purchase

Owner

For product information see serial number plate on the structure under the seat.

Manufacturer

**ELECTRIC
MOBILITY EURO**

Electric Mobility Euro Limited

Canal Way, Ilminster, Somerset TA19 9DL

Company Registration in England No. 2419231

Features and Layout

Photo shows the WeGo 250 Powerchair. See the specification for detailed weights and performance (p25).

Fold up and width adjustable armrests

Under-seat storage compartment

Solid tyres all round

Lift up footrest (with lifting handle)

Charging point

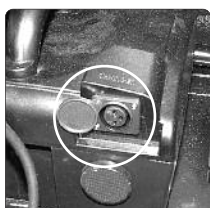

Attendant Tiller
On/off switch,
speed control and
paddle controls,
forward/reverse

Backrest

Battery pack

Passenger
Transfer Lock



Freewheel lever



Safety Information



**Read this manual thoroughly before using or operating the powerchair.
This handbook is applicable to the Rascal WeGo 250 Powerchair.**

If you have any doubt about the content of this manual phone your dealer to resolve the problem. Please read this manual, and ensure your powerchair is serviced regularly.



Within this manual there are important safety notices. They are clearly marked with the sign (left) Make sure that you understand all these notices. If you have any doubt, contact your dealer.



Book symbol: Read the product manual before assembling or operating the powerchair.

The following symbol appears on the product and in this manual in various locations:



Pinchpoint symbol: Wherever you see this sign there is a nearby risk of injury owing to a pinch or crushing point.

© 2009 Electric Mobility Euro Ltd.

No liability is assumed with respect to the use of any information contained in this publication. While every precaution has been taken in the preparation of this publication Electric Mobility Euro Ltd. assumes no responsibility for errors or omissions nor is any liability assumed for damages resulting from the use of information contained in this publication. This publication, as well as the operational details described herein, is subject to change without notice.

Intended use of the powerchair

This powerchair is designed for use by adults with a disability (up to the maximum recommended weight – see the Technical Specification - p25) who require a comfortable attendant operated powerchair which is easily transportable in the average family car.

This powerchair is intended for use in the home and for shopping areas and trips on reasonably paved areas.

Attendants could endanger themselves and/or others if they are not capable of driving this powerchair safely. Dealers will advise on the most suitable vehicle from the Electric Mobility range, but it is the responsibility of attendants to ensure that they have the manual dexterity to operate the vehicle, adequate sight and hearing to perceive danger in time, and can at all times operate the powerchair safely in the expected conditions. If in doubt we suggest you consult a healthcare professional or your nearest dealer for advice on the most suitable powerchair for your particular condition. Attendants should also regularly assess their ability to operate the powerchair safely.

This Powerchair has small front wheels for good manoeuvrability so it should not be used on uneven, potholed or rutted surfaces or slippery grassy areas. Kerbs should be avoided but this powerchair can mount small obstacles up to 25mm (1").



Safety Information

General Warnings

- Warning !** The operation of Powerchairs can endanger the life of the attendant, passenger or third parties. Any attendant should **always** be fully capable of operating this vehicle safely.
- Warning !** Sitting for long periods may increase the chance of thromboses or pressure sores. Passengers prone to such conditions are advised to take medical advice.
- Warning !** These Powerchairs have been designed and tested to carry up to the maximum recorded weight in the Technical Specification (p25). This weight **must not** be exceeded.
- Warning !** Do not exceed the specification; do not modify this powerchair or use it other than as a powerchair.
- Warning !** Passengers. Additional passengers, even children, should never be carried.
- Warning !** Electromagnetic interference may affect the performance of this Powerchair:
- Do not operate devices such as CB radios or mobile phones while the vehicle is switched on.
 - Avoid getting close to transmitter masts, such as television and radio stations.
 - If your vehicle ever starts to operate by itself switch it off and report this to your Dealer.
- Warning !** The operation of any Powerchair may affect sensitive electronic circuits such as alarm systems, garage door closing mechanisms, or automatic doors in shops.

Driving

Before driving, refer to "Driving Your Vehicle" ...later in this manual

- Warning ! Freewheel device/mode. Attendants & Passenger-** Before getting on the Powerchair, always check that the freewheel lever is in the "Drive" position. When the lever is in the Freewheel position there is no braking and the Powerchair could run down a slope and cause injury or even death.
- NEVER SIT ON THE POWERCHAIR WHEN IN FREEWHEEL MODE UNLESS AN ATTENDANT HAS FIRM CONTROL OF THE POWERCHAIR AND IS NOT INTENDING TO LEAVE YOU ON YOUR OWN.**
- Warning ! Passenger Transfer Lock.** Attendants: Before allowing your passenger to transfer in to or out of the powerchair, make sure that the passenger transfer lock is in the engaged (ON) position. This lock provides additional stability for the powerchair during passenger transition to and from the seat. Before driving the powerchair, ensure that the passenger transfer lock is in the disengaged (OFF) position.
- Warning ! Transferring On and Off. Passengers:** Do not attempt to get on or off your Powerchair unless it is switched off, at rest, and on a stable, level surface. Never get on or off on a hill.
- Warning ! Damage. Attendants:** Before driving off check the Powerchair for damage, particularly that which might affect the controls, wheels and drive motor.
- Warning ! Footrest. Attendants & Passengers:** Before switching on the Powerchair, always put the footrest down and make sure the passenger's feet are firmly on it. If you drive forward with your passenger's feet still on the ground, their feet could become trapped under the Powerchair and serious injury could result.
- Warning ! Armrests. Attendants & Passenger:** Do not allow the passenger to use armrests as a support when getting in or out of the powerchair. Make sure the armrests are lowered and secure before you start off otherwise the passenger may fall out.



-
- Warning ! Seat Belt. Attendants & Passenger:** The passenger should have their seatbelt fastened before the powerchair is operated.
- Warning ! Battery Charge Level. Attendants:** Before driving off always check the battery indicator. If you are in any doubt, ensure all the batteries are fully charged before starting on a journey.
- Warning ! Castoring. Attendants:** Be aware that, if you set off when the castors are not straight, the initial movement could be sideways.
- Warning ! Power. Attendants:** Unless there is an emergency, do not switch the power off when moving. The Powerchair may stop very suddenly. Release the forward / reverse control and the Powerchair will come to a controlled stop.
- Warning ! Slopes. Attendants:** On steep slopes the Powerchair could topple over. Always try to avoid crossing a slope. If you have to cross a slope, take great care to avoid tipping. Never make sharp turns on slopes. Never drive on slippery or icy slopes. - If you are not comfortable with the hill gradient, consider an alternative route. See Driving Your Vehicle – Hazards for more advice.
- Warning ! Kerbs. Attendants:** You should always try to avoid driving up or down kerbs as this may cause the Powerchair to topple. Use access ramps wherever possible. Never attempt kerbs greater than that in the Technical Specification. If you have to climb or descend a low kerb, always tackle it straight on. Make sure that your passenger is properly seated, with the seatbelt secured and prepared for the manoeuvre. See Driving Your Vehicle – Hazards for more advice.
- Warning ! Speed. Attendants:** Turning at maximum speed might cause the Powerchair to topple over. Always slow down for turns. Always slow down when amongst pedestrians and ensure you do not run into them.
- Warning ! Stopping. Attendants:** If the Powerchair stops suddenly when turning, the Powerchair might topple. Try not to brake when turning. Always take particular care when turning.
- Warning ! Reversing. Attendants:** Always take particular care when reversing as injury to feet and ankles could result from failing to maintain a safe distance from the rear of the powerchair.
- Warning ! Leaning Over. Passenger:** Do not lean sideways, as this could cause the Powerchair to topple.
- Warning ! Escalators. Attendants:** Never drive this Powerchair onto an escalator as this could cause toppling and result in severe injury.
- Warning ! Roads. Attendants:** Powerchairs are not for use on roads, apart from crossing roads at designated places.
- Warning ! Driving in Poor Visibility. Attendants:** Powerchairs are not easily seen. Your powerchair is not intended for use outdoors in darkness or in poor visibility.
- Warning ! Fixing of Seatbelts. Attendants & Passenger:** On reassembly of the powerchair please make absolutely sure that the seat belts have not become detached from the powerchair.
- Warning ! Attendants & Passenger:** If the vehicle is left out in the sun, surfaces could become extremely hot. Always try to park the vehicle in the shade.
- Warning ! Attendants and Passenger:** This powerchair is not suitable for use as a seat for an occupant when in a motor vehicle.

Component Overview

1. Front Section
2. Rear Section
3. Swivel Seat
4. Battery Pack – incorporates re-settable safety cut-out and charging point
5. Attendant Control System – Tiller Unit

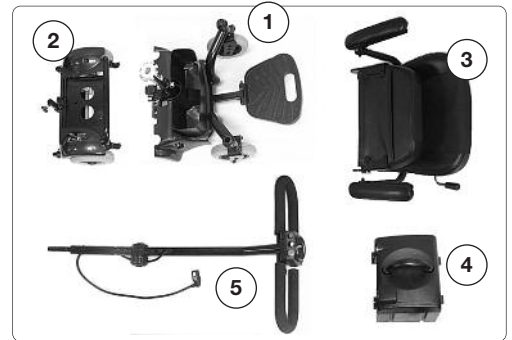

Controls – Attendant control assembly

Before driving your vehicle it is important to familiarise yourself with the controls. Do not attempt to drive the vehicle before reading the rest of this Handbook.

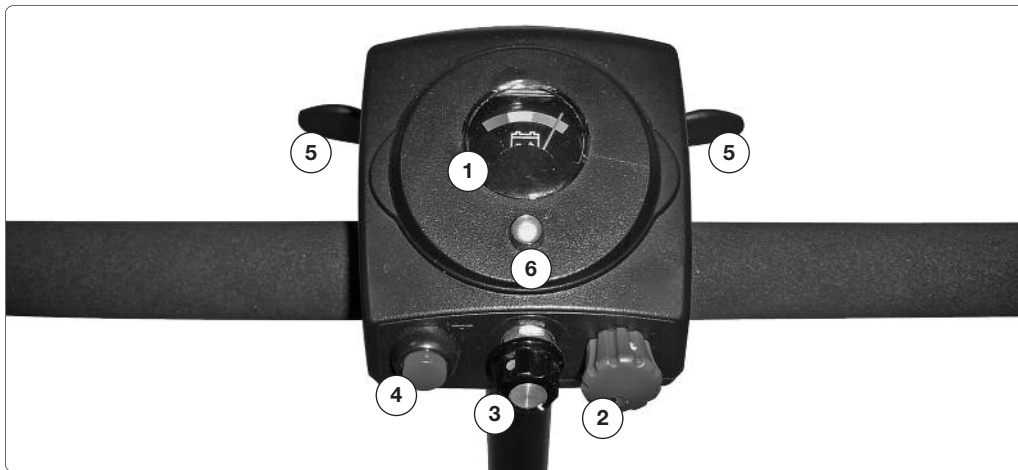

Description of the Controls

- 1. Battery condition Indicator:** This meter shows the level of charge in the batteries. When in the green section the batteries are fully charged. When in the yellow and red sections, the batteries need recharging and when in the red section the batteries urgently need recharging. Note: When the vehicle is climbing an incline or starting off, the level may drop momentarily; this is normal.
- 2. Power On/Off key:** Switch the power to the powerchair on and off by inserting or withdrawing the key provided. Remember to switch off when not in use. Do not leave the power switch on when not in use, especially when charging the vehicle. Note that this switch can also be used to “immobilise” the Powerchair to help prevent it being used, or stolen.
- 3. Rotary Speed Control:** This control enables the attendant to increase or decrease the pre-set top speed of the Powerchair. When the control button is rotated in a clockwise direction, the maximum speed the Powerchair can achieve is increased; when the control button is rotated in a counter-clockwise direction the maximum achievable speed is reduced. Set the maximum speed to low until you are confident in driving the Powerchair safely. Do not adjust the speed when the vehicle is moving, but reset it when you are stationary. If you become alarmed at your speed release the forward/reverse paddles and the vehicle will slow down immediately.
- 4. Horn:** Press the button and the horn will sound. Release and the horn will cease.

-
- 5. Paddle Speed Controller:** This is operated by the attendant using both hands on the control paddles. The left hand paddle controls reverse speed and the right hand paddle controls forward speed – both to a maximum as pre-set by the rotary speed controller in (3) above. As the paddle is pulled back towards the operator the powerchair will steadily increase in speed; either forwards or backwards depending on which paddle is being pulled. **NOTE:** When reversing the powerchair, an audible beeping will be heard. This is quite normal and is designed to warn people of the hazard of a powerchair reversing in their immediate vicinity.
- 6. Power on Indicator / Status LED:** This indicator shows the status of the powerchair – either on or off. A solid green light indicates that the powerchair is on and ready to use and no light means that the powerchair is off or totally discharged.

Note. The controller has a diagnostic mode: If the LED flashes, this indicates that the controller has detected an error or fault. If this happens refer to the diagnostic table at the back of this manual for a solution.

Tip: One of the most common “faults” is that the powerchair has been switched on with the free-wheel function enabled and/or the passenger transfer lock is engaged – Just remove the power on/off key, position the freewheel lever in drive, ensure that the passenger transfer lock is disengaged (OFF) and replace the on/off key.

Controls – Driving Controls/Accelerator

Before driving your vehicle it is important to familiarise yourself with the controls.

Warning! Paddle controls. To operate, ensure the powerchair is NOT in free-wheel mode, the Passenger Transfer Lock is disengaged & that the power on/off key is inserted.

Stand behind the powerchair and adopt a comfortable stance whilst resting your wrists on the tiller bars – this will help reduce the risk of a jolt causing the paddles to be moved and an involuntary change in direction or speed. Find an open level area with no obstructions to practice controlling the vehicle until you are confident that you can drive safely.

NOTE: To avoid excessive strain on the tiller assembly, never push the powerchair in freewheel mode if a passenger is on-board.



Going Forward or Backwards. Pull the left paddle towards you and the powerchair will move backwards, pull the right paddle towards you and the powerchair will move forwards. The further you pull the paddles, the faster you will go. Releasing the paddles will quickly bring the powerchair to a stop. **Tip: Never** pull both paddles together. The paddle direction control can be reversed. Please contact your dealer for support.

Turning Left or Right. Apply left or right force to the tiller delta handle bars.

Braking. Whenever the paddles are released, the automatic brake will operate. Practice stopping on level ground to ensure that you know how quickly you can expect your Powerchair will come to a stop.

Paddle Disabling during Start-Up. To prevent sudden unexpected movements the paddles are disabled during start-up. If the paddles are operated when the power key is inserted, the status indicator LED will give 6 flashes and it will not be possible to drive the powerchair. Re-set this safety control by removing the power key and re-inserting it.

Ask your dealer to demonstrate all these functions and make sure you can operate all the modes of the controller before you take your powerchair home.



Freewheel Device

When the powerchair is switched off the brakes are automatically engaged. This is called “Failsafe Braking”. Also, if the batteries are flat, the brakes are applied. There may be occasions where you may wish to move the vehicle without power. To do this there is a Freewheel Device fitted on the motor.

The Freewheel device allows the vehicle to be pushed without power. To activate, first locate the lever on the right hand side of the chair (seen from behind), adjacent to the battery- see Illustration.

- Make sure the power is switched off.
- Move the lever into the freewheel position. The vehicle can now be pushed in Freewheel mode. Get your dealer to show you.
- Move the lever to engage drive. The vehicle is now braked. This is the normal operating position.

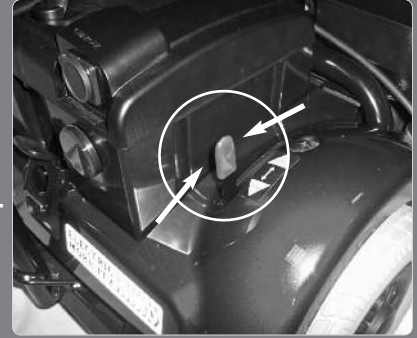

IF YOU ARE NOT COMPLETELY SURE OF THIS FEATURE CONTACT YOUR DEALER BEFORE OPERATING THE POWERCHAIR.

NOTE: To avoid excessive strain on the tiller assembly, never push or pull the powerchair in freewheel mode if a passenger is on-board.

Push the lever **FORWARDS** to engage freewheel mode. Pull the lever **BACKWARDS** to engage Drive mode.

Warning! If the freewheel devices are in “freewheel” mode the braking is disabled. Never select the freewheel mode if the Powerchair is on a slope or could be pushed onto a slope.

Passenger Transfer Lock

In order to improve lateral stability as the passenger transitions to or from the Powerchair, a manual Passenger Transfer Lock is provided. You must never drive the Powerchair with this lock engaged or turned on however it is essential that you engage (turn ON) the lock as the passenger transfers to or from the powerchair. Push the lever forwards to disengage and backwards to engage.

If you do drive the Powerchair with the lock engaged / ON, the diagnostic LED will blink and the lock will need to be disengaged (turned OFF), the power key removed and then replaced.



Brakes

There are 2 braking systems. The first works with the paddles. When the paddles are released the Powerchair will automatically brake. When the Powerchair stops the automatic brake will engage. This will stop the vehicle rolling forward or backward. When you start, the brake will automatically disengage. If the battery becomes very low or exhausted, the brakes automatically engage. Note that even when freewheel is selected, a secondary braking system is applied automatically to limit the maximum speed. You may notice this system when moving the Powerchair in freewheel.



Warning! If the freewheel devices are in “freewheel” the braking is disabled. Never select the freewheel devices if the Powerchair is on a slope or could be pushed onto a slope.

Armrest Width Adjustment

If you require more room in the seat width loosen the armrest width adjustment using the thumbwheel as shown as shown. Slide the armrests in or out to suit, and tighten up the thumbwheel bolts, making sure that the armrests are equidistant from the centre of the seat and secure.

Re-tighten the thumbwheel bolts. If you do remove the armrest completely (not recommended), be very careful to ensure that the seat belt does not become detached from the assembly. If you are in any doubt, please consult your dealer. Finally tighten the thumbwheel bolts and ensure that the armrests are secure.



Armrest Angle Adjustment

The armrest angle can be adjusted by flipping up the armrest, and loosening the nut near the pivot point. Then, using an Allen key turn the armrest adjustment screw clockwise to lower the end of the armrest or anticlockwise to raise it. Once satisfied, tighten the nut and lower the armrest.



Warning! Passenger: Do not use the armrest as a support when getting in and out of your Powerchair – Armrests are not designed to fully support your weight.



Swivel Seat Use

This allows easy access

- To operate, locate the release lever under the seat.
- Pull the lever up and the seat will release allowing it to rotate.
- Release the lever and the seat should lock automatically, but always check it has.



Warning! Do not use this device if the vehicle is on a slope. Always check the seat is locked in the forward position before driving the vehicle.



Seat Back Folding

The Seat Back can be folded forward for transporting only. Never drive the powerchair with the seat in the folded forward position.



Warning! Always return the seat to the upright position before starting off. If the seat back is tilted forwards in the flat or prone position, the patient / passenger very likely to fall and suffer injury, especially if travelling up ramps, kerbs or hills.

Footrest Adjustment

For comfort and to achieve correct posture, the footrest angle can be adjusted. Please ask your dealer to make these adjustments to ensure your legs are in a comfortable position.

Attendant Tiller Adjustment

The tiller unit can be adjusted to provide the best / most comfortable angle for the attendant. In order to change this angle, loosen the thumbwheel shown in the image adjacent, move the tiller to the desired angle and then fully re-tighten the thumbwheel.

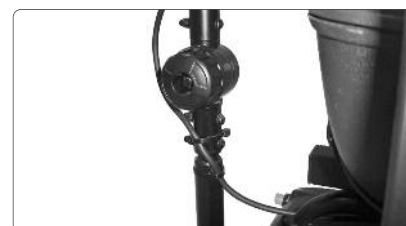

Warning! Never adjust the tiller angle so that safe operation cannot be achieved. Always check that the tiller angle adjustment thumbwheel is fully tightened before operating the powerchair.

Transferring In And Out Of The Powerchair

If you feel at all uncertain about getting in or out of the powerchair seek assistance.

Transferring into the Powerchair from the Front

Before getting in:

Attendants:

- Make sure that the powerchair is on a level surface, and it is not in Freewheel mode.
- Make sure the brakes are engaged - try and push the powerchair a little to verify that the brakes are working.
- Engage the Passenger Transfer Lock (switch ON)
- Ensure that the power is turned off.
- Raise the footplate .
- The seat should be facing forwards and locked. Try to rotate it to verify it is locked.

Now the passenger is ready to get in:

Passenger:

- With your back to the chair, you can steady yourself using the armrests and then lower yourself gently into the seat.
- Make sure that you replace the footrest in its normal position and that you have your feet in place on the footrest.
- Apply and adjust the seatbelt so that it is comfortable.

Don't worry if you cannot perform all of these operations on your own, your attendant will be there to help!

Transferring into the Powerchair from the Side

Before getting in: Attendants:

- Make sure that the powerchair is on a level surface, and it is not in Freewheel mode.
- Make sure the brakes are engaged - try and push the powerchair a little to verify that the brakes are working.
- Engage the Passenger Transfer Lock (switch ON).
- Ensure that the power is turned off.
- Raise the footplate .
- Move the seat so that it is facing sideways. Try to rotate it to verify it is locked.

Now the passenger is ready to get in: Passenger:

- With your back to the chair, you can steady yourself using the armrests and then lower yourself gently into the seat.
- Rotate the seat to the fore and aft position and ensure it is locked in that position.
- Make sure that you replace the footrest in its normal position and that you have your feet in place on the footrest.
- Apply and adjust the seatbelt so that it is comfortable.

Don't worry if you cannot perform all of these operations on your own, your attendant will be there to help!

Getting out of the Powerchair:

- Attendants: Before the passenger gets out either assisted or unassisted , be sure that the powerchair is on a level surface, is not in freewheel mode and the power is off. If you feel uncertain about getting out, get assistance.
- Engage the Passenger Transfer Lock (turn ON).
- Passenger: Position yourself with your feet either side of the footplate and
- Raise the footplate (s) to the vertical position.
- Stand up without putting excessive weight on the armrests. The passenger may need some assistance.

Attendant Operation

Before using the WeGo 250 powerchair the attendant should make sure that:

- Battery is fully charged. (indicating green on the battery indicator)
- The user is seated and the seat-belt is properly adjusted.
- There is no sign of damage to the chair.
- The attendant must be capable of controlling the powerchair at all times.

Getting the passenger into or out of the powerchair: Before helping the passenger to get into the powerchair, make sure that the powerchair is on level ground, the Passenger Transfer Lock is engaged and the brakes are applied (not in freewheel mode). Before helping a patient to get out of the powerchair, park the powerchair on level ground, ensure the Passenger Transfer Lock is engaged, that freewheel mode is off (braking engaged) and that the ground is not slippery or uneven.

Kerbs and Obstacles: Try to avoid taking the powerchair over obstacles or kerbs. Tackle obstacles head on.

Bad Weather: We suggest that it is better to stay at home in bad weather. Remember that the passenger can become wet and cold. Suitable clothes should always be worn. A high visibility jacket should be considered if you are in poor visibility.

Driving Your Vehicle

Read this before driving your powerchair



Warning! Whether or not this is your first mobility vehicle, please read these guidelines as all vehicles differ. Failure to do this may cause damage to you, a third party or the vehicle.

Before you set out, do check the weather forecast. We suggest that you make sure you are wearing suitable clothing, whether your journey is long or short.

Range. Your powerchair has a limited range. Always ensure that your planned journey does not exceed the maximum range in the Technical Specification (p25) and that your battery is fully charged.

If you (the attendant) are taking medication check with your doctor or physician that your ability to control the vehicle will not be impaired and do not drink alcohol and drive. Attendants: Check that your passenger is well enough to be driven. This can be verified with their doctor / health carer.

Only use the vehicle for the purpose its intended for. Do not drive through water or on slippery surfaces; do not transport more than one person; do not tow other vehicles or carry excess weight.

Attendants: before seating your passenger in the powerchair, check that the freewheel lever is not in the Freewheel position / mode and that the passenger transfer lock is engaged (ON).

Check the battery charger is disconnected.

Check that the passenger is sitting properly and that the seatbelt is correctly fastened and adjusted.

Check that the Latch Lock Spacer is fitted (see “Transporting your vehicle” for details).

Check the backrest is upright

Ensure your passenger’s feet are securely on the footrest.

Check you have adjusted the seat as instructed in this manual.

Make sure the way ahead is clear.

Switch on the power. Check the battery level indicator is in the green area.

Speed Control. Set the speed control to a low setting.

Disengage the Passenger Transfer Lock.

Gently actuate the paddles (either forward or reverse) and steer the passenger in the direction required. The vehicle will now move off. The further you pull the paddle (either forward or reverse) the faster the vehicle will go.

To brake, return the paddles to the neutral position. If you become unsure or feel unsafe release the paddles immediately.

As you get accustomed to the power you can increase the speed.

Switch Off when Not in Use. To conserve your batteries and prevent the vehicle accidentally moving, always turn off the power when your Powerchair is not in use.

Driving Your Vehicle - Hazards



Before driving the Powerchair you should be aware that, under certain circumstances it could become unstable and tip over. The Powerchair has been designed to operate on paved, even surfaces and should not be used on rough, rutted, soft or slippery terrain.

Getting on and off the vehicle: Attendants: Before your passenger mounts the powerchair make sure that the it is on level ground, and not in freewheel mode. Ensure that the armrests are secure. Before the passenger gets off, park the powerchair on level, stable ground, and switch off. Make sure the passenger gets off the vehicle in a safe area.

Kerbs and Obstacles Attendants: Always try to avoid kerbs and obstacles. Never ride up or down kerbs or obstructions higher than that in the Technical Specification (p25). Always tackle obstacles head on. Use ramps wherever possible and ensure that all wheels will fit on the ramp safely. Never drive or turn across a slope or back down a slope. Note that the anti-tip rollers at the rear of the Powerchair may contact the kerb as you descend; this is normal.

Hills & Slopes: Going Up Hill. Attendants: Remember that the seat back should be in the upright position and that the passenger must be properly seated. Make sure you have enough speed to climb the slope. **Do not stop or turn the vehicle around.** If you have to turn while climbing an incline, keep going until you reach a level area. If you are not comfortable about tackling a gradient, consider an alternative route.

Note: Always check that the battery level is high; going up hill takes a lot of energy. If the level drops too low the vehicle will cut out leaving your passenger stranded.

Hills & Slopes: Going Down Hill. Ensure that the passenger is properly seated. Turn the speed control dial to low. If you are not comfortable about tackling a gradient, consider an alternative route.

**Try to avoid crossing slopes – always try to drive straight up and down the slope
NEVER BACK DOWN A SLOPE!**

Attendants:

Turning: Always Slow down before a turn; turning at speed can cause the powerchair to topple. Look in the direction you are travelling – If there is a blind corner sound the horn.

Turning Circle. So you can judge the turning circle, practice manoeuvring the powerchair. This is important to avoid tipping off kerbs, and when going into and out of lifts or entrances.

Terrain. Do not drive the powerchair across soft terrain (for example, soft dirt, mud, sand, or loose gravel). You could get stuck. Also avoid rutted bumpy ground and keep to well prepared paths.

Bad Weather: If it is snowing or icy stay at home! Remember that ice, snow and slippery surfaces such as manhole covers, wet grass and drains could affect braking and steering. Use caution at all times.

Shower Rooms or Washing. Never take the powerchair into a shower or steam room, and never hose it down. It's sensitive electronics could malfunction if they get wet or damp.

Tyres: Your vehicle is fitted with solid tyres that will not puncture. Should they become damaged they should be replaced by your dealer. Do not attempt to replace them yourself.

Transporting Your Powerchair



Warning! Dismantling the powerchair involves lifting and handling heavy parts.

Warning! Pinching or Crushing. Be careful to avoid being pinched or having your hands crushed when lifting or handling parts. Wear gloves whenever possible. Special attention should be paid when raising and lowering armrests, making adjustments to the footrest angle, splitting the front and rear parts of the chassis or rotating/handling the front wheels when dismantling or re-assembly for transportation in a car or similar.

Warning! This powerchair is not suitable for use as a seat for an occupant in a motor vehicle.

Warning! Do not lift the chassis with the batteries still fitted - back injury may result!

Your Powerchair has been designed to be dismantled and stowed in a car. Contact your dealer for advice on how best to transport your powerchair in your vehicle. This may involve using ramps. To transport your Powerchair you will need to dismantle it. Follow these instructions. The component weights are recorded in the Technical Specification (p25). Do not attempt to undertake dismantling or lifting without assistance. You are advised to wear gloves.

- Turn the power off.
- Disconnect the main controller cable (fig 1). You will need to undo the velcro cable tie that secures the control wire to the powerchair chassis. – Don't forget to reattach this when re-assembling the WeGo 250.
- Loosen the tiller thumbwheel and carefully extract the whole tiller assembly from its socket (fig 2)
- Remove the seat by gripping the seat lock lever, pulling up and lifting the seat off the chassis. (fig 3)
- Fold the seat arms down & the seat forward on itself for easy storage.
- Remove the battery pack (fig 4). Warning, these parts are heavy!
- Remove the Latch Lock Spacer. (fig 5).
- Split the front and rear sections of the chassis by pressing down on the lever directly behind the seat post. (fig 6)
- Stow the parts into the boot of the vehicle (fig 7).
- Ensure that all parts are secure so that they cannot move while driving.

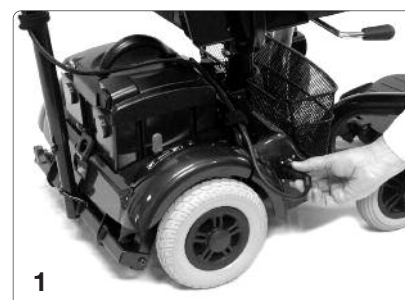

Assembling your Powerchair following Transportation

Warning! Assembling the Powerchair involves lifting and handling heavy parts. The Powerchair has been designed to be easily assembled. Your dealer should advise you on the best way to assemble your Powerchair.

Warning! Pinching or Crushing. Be careful to avoid being pinched or having your hands crushed when lifting or handling parts. Wear gloves whenever possible.

Warning! Never unload your Powerchair on sloping, or uneven ground. It could run down the slope and injure someone. Avoid placing it on soft ground as it might get stuck or tip over.



After removing your Powerchair components from a vehicle and placing them on level ground, assemble as follows:

- Check parts for any sign of damage before assembling them.
Tip: To help stabilise the two halves of the chassis and to make reassembly easier, insert the tiller into the tiller socket (fig 1) and fully tighten the thumbwheel.
- Holding the tiller with one hand carefully place the front and rear chassis sections together and clip together. When properly located a “clunk” will be heard.
- Insert the Latch Lock Spacer (fig 2)
- Replace the battery pack in the chassis (fig 3). Again this will locate positively and a “clunk” will be heard
- Refit the tiller into the socket and tighten the thumbwheel fully. Ensure that this is secure.
- Check that the cable grommet is in place where the cable enters the tiller.
- Plug the control cable coming from the tiller into the socket being very careful to reattach the cable to the frame with the velcro cable strap provided (fig 4).
- Replace the seat as follows:
 - Put the seat arms in the upright position to make handling easier, raise the entire assembly onto the seat post while gripping the seat lock lever (fig 5).
 - Lower the seat onto the seat post.
 - Release the seat lock lever
 - Make sure that the seat lock is engaged by trying to rotate the seat. If it is not engaged, lift the seat a little, raise the seat lock lever, lower the seat, and release the seat lock lever.
 - Check the seat is secure.
- Select power on and ensure that the battery level indicator shows green. If not charge the Powerchair before use.
- Check the freewheel lever is in the “drive” position /mode and not in the “freewheel” position
- Test the operation of the paddles, speed control and on off switch before using the Powerchair to go anywhere. If there is any malfunction, check that control connection plug assembly from the attendant tiller has been correctly inserted into the socket on the power-chair.
- Engage the Passenger Transfer Lock (switch ON).

The power-chair is now ready for use.

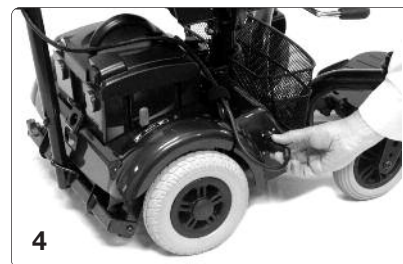
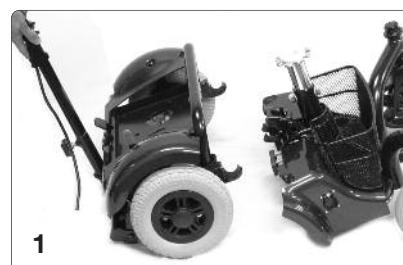

Battery Charging



Warning! When charging batteries **NEVER** smoke or charge batteries in a place where there are naked flames such as gas-fired heaters as, under exceptional circumstances, batteries may give off gases that could ignite and explode. Always make sure that battery box is not damaged. Never charge the powerchair out of doors as the charger is not designed to get wet.

Warning! It is strongly recommended that the mains socket used for charging the powerchair is protected by a 30 mA RCD (residual current device). Many buildings have sockets protected by a system based RCD. If you are in doubt as to the level of protection in your charging location then either purchase a plug in RCD or consult a qualified electrician to verify that your charging location mains sockets are protected.

Warning! When charging batteries **NEVER** connect or disconnect the charger from the powerchair while it is still connected to the mains. – Remove the charger mains plug from the wall socket having first switched the mains socket off if a switch is provided.

The charging socket is located on the top right hand side of the battery unit underneath a protective swing cover.

Open the protective cover and with the charger disconnected from the mains, push the charger plug into the socket on the battery pack.

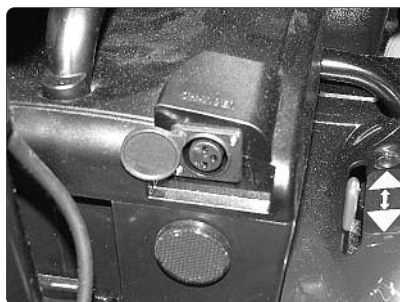

Plug the charger into the mains wall outlet and switch the outlet on if a switch is provided. When the vehicle is charged remove the mains plug from the wall socket and the charging plug from the powerchair. Then reposition the cover over the charging socket to keep the dirt and moisture out.

The battery charger has an indicating lamp that changes colour depending on the charge state of the batteries. When the charger is connected and switched on the lamp will illuminate red. When the batteries are fully charged, the charger lamp will illuminate green.

- Red - Power on - not charging
- Green/Red - Charging
- Green - Fully charged
- No illumination - mains not connected to charger.



Warning! Never disconnect a battery while the charger is connected to the mains. Never charge your powerchair outside or where the charger may get wet.

Tip: The battery pack can be removed from the powerchair for offboard charging if required.



Charging your Batteries

Connection Instructions

When you receive your vehicle the batteries are only partially charged – always fully charge them before use preferably over-night. Always fit the full set of batteries before charging.

- Place your machine in an area that is dry and well ventilated. Make sure an RCD protected power point is nearby.
- Check the vehicle is switched off.
- Check the mains switch is off and the charger mains plug. Never connect or disconnect the charger with the mains on.
- Connect the charger to the charging point as above.
- Connect the mains plug to the wall socket and switch on the wall socket switch if provided Check that the power light shows red/green indicating that charging has started.
- The charger lamp shows red/green (charging) and then changes to green when the battery is fully charged.
- Wait until the charger lamp turns green indicating that the batteries are fully charged
- Switch off the mains switch if provided, remove the mains plug from the wall outlet and remove the charging plug from the battery unit. Do not leave the charger plugged in to the powerchair with the power off. This will gradually discharge your battery.

Charging your Batteries

The batteries are the lifeblood of your vehicle. Their characteristics can change depending on charging, temperature, usage and other factors. Listed below are guidelines to prolong battery life.

- After using the powerchair, always charge it at the end of the day - even after a short journey.
- If you do not use the vehicle for a prolonged period, place it on charge once a week, overnight.
- Always use the correct charger with the correct batteries. The WeGo 250 can only be used with the charger model : **HP1202-B** or equivalent charger approved by Electric Mobility.
- If the batteries have been flat for a long time (about 2 months) it is recommended you contact your dealer before charging, see warning below.
- Do not charge the vehicle in the open – it may rain and the battery charger is not waterproof / suitable for outdoor conditions.
- Keep the vehicle in a well-ventilated area and away from any naked flame.
- Do not part-charge the batteries. Allow the charger to complete its cycle for every battery fitted.

Notice Return your unserviceable batteries to your supplier or ensure they are disposed of in accordance with the environmental regulations applicable at the time.

Warning! If batteries are damaged or frozen they could heat up when charging and, in an extreme case, explode.



User Maintenance

It is important for safety that you carry out the following checks before use.

- **Visually check the machine for damage.**
- **Visually check the tyres for damage.**
- **Check that the seat and tiller are secure.**
- **Ensure that all thumbwheels are tight**
- **Check the armrests are secure** and that both seatbelt halves are attached to the armrest supports.
- **Ensure that the tiller cable is securely held to the chassis** with the fastening band supplied.
- **The Battery is fully charged.**
- **Check the operation of the brakes** and if you have any concerns, contact your dealer.
- **Keep your vehicle clean** by using a damp cloth and soapy water – **never** use a hose.

Important - Possible faults

As you get used to the powerchair you will get a feel for how it behaves. If something feels unusual, for instance the vehicle does not accelerate or brake smoothly, the vehicle tries to turn to one side, the brakes are not holding on a slope or the controller operates strangely, contact your dealer immediately and explain to the engineer exactly what the problem is.

Disposal

Contact your dealer for advice before you consider disposing of your powerchair. They will be aware of the environmental regulations in force at the time and will assist you to meet the applicable environmental legislation.

Servicing and Maintenance

This vehicle is designed for minimum maintenance. However it is recommended that a competent engineer service the vehicle at least once a year. If the vehicle is used constantly we recommend a twice yearly maintenance.

Ensure the engineer stamps the Service Log on completion for all servicing carried out on this vehicle. Keep all receipts for servicing and repairs with this handbook. This may add value when selling the vehicle.

When the vehicle is due for it's service make sure you report any concerns you have, preferably when you book the service (see points to look out for below).

On completion of the service, always test the vehicle before the engineer leaves and make sure you are satisfied with the work carried out.

Points to look out for:

- Are there any strange noises from the wheels or does the frame creak ?
- Is the battery charging up correctly – is the “full” charge green light on after charging ?
- When turning, does the Powerchair respond equally to left and right turns ?
- Does the Powerchair stop smoothly when paddles are released ?
- Does the Powerchair tend to pull to one side ?
- Does the speed control work ?
- Does removal of the key disconnect all power to the powerchair ?
- Has anything come loose ?
- Does the vehicle perform as well as it did when it was new ?
- Are there noises or rattles that were not there before ?
- Are there any signs of damage, corrosion or cracking ?
- Is the tiller cable retaining strap still in place and correctly positioned ?

Engineer's Checklist for Powerchairs

Obtain all comments from the customer on the condition and serviceability of the Powerchair and then complete an Initial diagnostic road test. Record all defects to be corrected. Now check, test and complete the following:

- Wheel bearings for wear and lubricate
- Operation of the paddles.
- The On/Off key switch for correct functioning
- The speed indicator for correct indications
- The Speed Increase and Decrease paddles for correct operation
- Wear or damage to tyres or wheels
- Bodywork fixtures for damage, corrosion or cracking – ensure that all warning labels are in place and visible.
- Operation of securing knobs. Do they secure the armrests & tiller? Do they need replacing?
- Operation of armrest attachment. Thumbwheel locks ? Do they tighten to secure the armrests ? Replace as necessary
- Paddle play, correct operation and response and carry out any necessary adjustment or replacement
- Battery contacts & signs of corrosion.
- Check all cables for damage, abrasion, corrosion and that screening is intact. Replace as necessary. Ensure that the tiller cable grommet and securing straps are present and fully functional.
- Seat mounting and catch for wear or damage
- Motor performance, excessive noise, leaks or damage.
- Motor speed check
- Tiller cable grommet properly positioned to protect cable?
- Electromagnetic brake operation
- Freewheel operation .
- Frame for damage or cracks
- General check for corrosion, repair or protect as necessary
- All operational controls work correctly
- Battery condition and charger operation
- Tighten all nuts & bolts
- Operation of the paddles in forward, reverse, turning, and stopping smoothly.
- Correct all defects found and determine if the vehicle is roadworthy.
- Final road test
- Clean vehicle
- Customer road test

Troubleshooting Guide

This table is a guide to fault finding. The fault may be a simple fix. If you have any doubts phone your dealer.

Symptom	Solution
<ul style="list-style-type: none"> • Powerchair does not move. when power is switched on. 	<ul style="list-style-type: none"> • Batteries flat - check level. • Is the charger connected? • Is Freewheel engaged or is the Passenger Transfer Lock still engaged (ON)? • Safety Cut-out has operated due to overload? Press the reset button on the rear of the battery box. If the cut-out operates again, contact your service agent for assistance. • Freewheel has been selected while power is on Ensure freewheel is not selected; switch off and on NB the power indicator may flash indicating that freewheel has been selected.
<ul style="list-style-type: none"> • Vehicle pulls to one side. 	<ul style="list-style-type: none"> • Check for tyre damage. • Possible Motor failure - contact dealer. • Binding Bearings – contact dealer
<ul style="list-style-type: none"> • Vehicle behaves erratically when driven. judders or cuts out ? 	<ul style="list-style-type: none"> • Possible electronic problems - contact dealer.
<ul style="list-style-type: none"> • Short Range 	<ul style="list-style-type: none"> • Check tyres for damage. • Check batteries are fully charging. • Check vehicle moves normally in Freewheel

Diagnostic Table

Your powerchair controller provides diagnostic information by lamp indications on the Battery Level Indicator. Individual lamps will flash to indicate a fault as below:

No. of flashes	Description	No. of flashes	Description
1	Battery needs charging	6	Not in neutral at power up
2	Battery voltage too low	7	Speed pot error
3	Battery voltage too high	8	Motor volts error
4	Current limit time out	9	Other internal error
5	Brake or Passenger Transfer Lock fault	10	Controller overheat

Your dealer is there to help you but they can only do this if you give them as much information as possible. Remember correct information will get the problem fixed quicker and save you money. Phone the dealer and explain exactly what the problem is, recounting as much detail as possible including the indicated faults.

Frequently Asked Questions

I want to transport my powerchair in a car.

There are various techniques. The WeGo 250 is designed to break down into very manageable units. Make sure your dealer has demonstrated the easiest way of loading your powerchair into your car. See transporting your powerchair.

Can I fit weatherproofing such as a canopy ?

No, the WeGo 250 Powerchairs are too small to have canopies as they can adversely affect stability and handling.

How long will my battery last ?

This is a difficult question as it depends on many factors. The life of a battery depends upon the number of cycles the battery goes through, the peak loads and on the conditions of use. Some general advice about battery care:

- Keep it charged, and do not let the battery run completely flat.
- Ensure all you battery is fully charged at the end of the charging cycle
- Batteries may not perform as well in very cold weather.
- Change your battery if you find it is not performing as well as new.

Care can prolong the life of the batteries but remember that, in time, all batteries will fail to perform to specification.

What range can I expect ?

The generally expected range shown in the Technical Specification (p25). However, range can be affected by many things such as:

- Temperature. Cold weather can reduce the output of the batteries.
- Type of terrain. Obviously climbing hills takes more energy than driving on the flat.
- Weight of the person.
- The condition and charge of the batteries.
- Faulty or old batteries or a faulty charger

Important Rule: Always use the correct charger with the correct batteries and ensure the battery is charged before you start out.

How long should I keep my powerchair before I change it ?

It is important that the vehicle you have suits your needs and abilities. Your Rascal Powerchair should serve you well for many years but change it if at any time you feel it no longer meets your needs. Consult your dealer on the condition of your vehicle and remember vehicles of any type become more expensive to maintain the older they get.

Additional Safety Information

Carrying Weight on the Wheelchair

Bags or Luggage: Never carry bags, except those specified as accessories or in the storage compartment beneath the seat; failure to note this warning could result in tipping over backwards causing injury or death. Only carry small bags on your lap and ensure they cannot affect the control of your vehicle.

Seat Arms: Do not carry or attach anything to the seat arms. Anything attached to the seat arms could affect stability, or interfere with the control of the vehicle.

Other Precautions

Paddles: Do not touch the paddles when the passenger/patient is getting in or out of the Powerchair; always make sure the Powerchair is switched off.

Modifications: Unauthorised modifications could result in injury or permanent damage. Such modifications will invalidate any guarantees.

Other Items: Only fit approved products or accessories.

Child Safety

This product is designed to be operated by adults. Children should not be allowed to tamper with the controls or play on the vehicle. **Do not carry children as passengers.** The product is designed for a single passenger only. Keep all packaging well away from children. They could be harmed

Additional Information

Owners Manual: Replacement copies are available from: Electric Mobility Euro Ltd. Canal Way, Ilminster, Somerset, TA19 9DL Telephone: 01460 258100.

If you are visually impaired, please contact the Company to discuss your requirements. However, you should not use a powerchair in a public place if you cannot see well enough to ensure your own, and others safety.

For Information regarding other Electric Mobility products contact your dealer or log on to the Electric Mobility Website www.electricmobility.co.uk

Technical Specification - Rascal WeGo 250

Powerchair type Class	Class A, B or C	Class B
Department of Transport Class	Class 1 2 or 3	Class 2
Overall dimensions fully assembled (including tiller control)	length x width x height mm (in)	1000 (39.4) x 600 (23.6) x 980 (38.6)
Dimensions seat folded	length x width x height mm (in)	1000 (39.4) x 600 (23.6) x 690 (27.2)
Maximum carrying capacity	kg (lb)	113 (250)
Mass (weight) including batteries	kg (lb)	46.8 (103.2)
Mass (weight) of front chassis	kg (lb)	10.6 (23.4)
Mass (weight) of rear chassis	kg (lb)	13.2 (29.2)
Mass (weight) of tiller	kg (lb)	3 (6.6)
Battery voltage and capacity	volts and ampere hours	12V 15Ah x 2
Mass (weight) of batteries (pair)	kg (lb)	10.1 (22.3)
Type of seat		Rotating standard seat with folding backrest and adjustable arms
Mass (weight) of seat	kg (lb)	10.5 (23)
Seat height adjustment to footrest	mm (in)	400 (15.7) to 490 (19.3)
Seat height adjustment to ground	mm (in)	500 (19.7) to 590 (23.2)
Seat width	mm (in)	470 (18.5)
Wheel size	front/rear mm (in)	single 178 (7) / rear 200 (8)
Type of tyres	type	Foam filled solid
Maximum speed	km/h (m.p.h.)	4.8 (3)
Minimum braking distance from maximum speed	m (ft)	0.76 (2.5)
Range on full charge and flat ground	km (miles)	Up to 8.8 (5.5)
The turn-around width	m (ft)	1.32 (4.3)
The maximum safe slope	degrees of slope	6° - Do not exceed. -The scooter may topple!
The maximum climbing ability facing upwards	degrees of slope	6°
Ground clearance	mm (in)	35 (1.4)
Maximum obstacle climbing ability	mm (in)	25 (1)
Maximum safe descendable kerb height	mm (in)	25 (1)

Due to a policy of continual improvements, Electric Mobility reserve the right to change specifications without prior notice.

Guarantee and Warranty

Lifetime Frame Guarantee

Electric Mobility Euro Ltd guarantees the frame of its vehicles to be free from defect in materials and workmanship under normal use as described in this document for the lifetime of the vehicle. Should a defect in materials or workmanship appear, Electric Mobility Euro Ltd, will repair, or at its option, replace the frame to the original owner.

One Year Limited Warranty

Electric Mobility Euro Ltd warrants its products against defects in material and workmanship for a period of one year, providing the products are properly assembled, operated and maintained in accordance with the vehicle Owners Manual. This limited warranty is limited to the original purchaser. This limited warranty commences on the date of the original retail purchase or original use, whichever occurs first, providing the warranty card is fully and correctly filled out and returned to Electric Mobility Euro Ltd Customer Service Department within 15 days from receipt of product. If a defective part appears within the stated limited warranty period and the purchaser has given Electric Mobility Euro Limited immediate notice the Company will repair the part or at its option replace the part with a similar part. No allowance will be made for repairs to any equipment without the expressed written or verbal approval of Electric Mobility Euro Limited. Any description, specifications, samples, models, bulletins or similar materials used in connection with the sales of Electric Mobility Euro Limited products are for the sole purpose of identifying the equipment and are not to be construed as expressed warranties. This limited warranty applies only to the original purchaser of the equipment and is not transferable. Electric Mobility Euro Ltd shall not be liable for special, indirect or consequential damage. Electric Mobility Euro Ltd's liability on any claim of any kind including negligence for any loss or damage arising out of, connected to, or resulting from the order of the performance thereof the design, manufacture, sale, delivery, resale, direction and instructions, inspection, repair or use of any equipment covered by or furnished by, under this order, shall in no case exceed the price paid by the purchaser for the equipment. This limited warranty does not cover normal maintenance service, or periodic adjustments necessitated by use of wear. Under no circumstances will charges for labour, consequential damage or repair expense be allowed after 30 days from receipt of product.

Technical Information Regarding EMI

Important Technical Information regarding Electromagnetic Interference (EMI)

The intensity of interference from electromagnetic energy is measured in volts per meter (v/m), which refers to the strength of the electrical source (voltage) as it relates to the distance away from the object being considered (in meters). Resistance of a scooter/wheelchair to certain EMI intensity is commonly called its "immunity level". 20 volts/meter is a generally achievable and useful immunity level against interference from radio wave sources (the higher the immunity level, the greater protection).

Your scooter has been tested and found to meet the required immunity level from Electromagnetic Interference (20v/m): the recommended density of interference from electromagnetic energy.



Warning! Even with the immunity level of 20 volts/meter, certain precautions must be followed to ensure your scooter/wheelchair will not be affected by outside electromagnetic sources.

- Do not operate devices such as CB radios or mobile phones while the vehicle is switched on.
- Avoid getting close to transmitter masts, such as television and radio masts.
- Note you may experience interference when close to ambulance or fire stations.

If your vehicle starts to operate by itself switch it off and report this to your Dealer.

Brochure Request

Do you have a friend or colleague that would be interested in an Electric Mobility product?
If so cut out this coupon and send it to the address shown on the back of the manual.

My Dealer's Company name is:	
<hr/>	
<input type="checkbox"/>	Please can I have a free no-obligation home demonstration.
<input type="checkbox"/>	Please send me a brochure of the range of products.
My friend's name is:	
<hr/>	
My friend's address is:	
<hr/>	
<hr/>	
County:	Postcode:
<hr/>	
My friend's telephone number is:	
<hr/>	

If you are visually impaired, please contact the Company to discuss your requirements. However, you should not drive a vehicle in a public place if you cannot see well enough to ensure your own, and others safety.

Postage will be paid by: Electric Mobility Euro Ltd., FREEPOST (SWBI 1045), Ilminster, Somerset, TA19 9ZA



Dealer Information - Warranty Card

This section is to be filled out by the Dealer and sent to Electric Mobility Euro Ltd.

Dealer:	
<hr/>	
Product Description:	
<hr/>	
Serial No.:	Invoice No.:
<hr/>	
Customer Name & Address:	
<hr/>	
<hr/>	
County:	Postcode:
<hr/>	
Telephone No.:	
<hr/>	
Date received at Dealers:	
<hr/>	

Postage will be paid by: Electric Mobility Euro Ltd., FREEPOST (SWBI 1045), Ilminster, Somerset, TA19 9ZA



**Electric Mobility Euro Ltd.,
FREEPOST (SWBI 1045),
Ilminster,
Somerset,
TA19 9ZA**

**Electric Mobility Euro Ltd.,
FREEPOST (SWBI 1045),
Ilminster,
Somerset,
TA19 9ZA**

Service Log

Notice for the Service Engineer.

Please make sure this part is stamped and dated after each service.

Dealer stamp - 1st Service

Dealer stamp - 2nd Service

Dealer stamp - 3rd Service

Dealer stamp - 4th Service

Dealer stamp - 5th Service

Dealer stamp - 6th Service

Dealer stamp - 7th Service

Dealer stamp - 8th Service

Notes

Notes

Rascal Powerchair Model WeGo 250

Manufactured by



Electric Mobility Euro Limited, Canal Way, Ilminster, Somerset TA19 9DL
Telephone: 01460 258100 www.electricmobility.co.uk

E. and O.E. Issue 1: 11/09